

TRACT I

69 Acres

Ideal for Aviation/Aviation Support

Located in Federal Opportunity Zone



County

Majority in Greenville County, small portion within Spartanburg County

City Limits

None

Location

Southeast side of the GSP runway and west side of GSP Dr, tract fronts along the east side of the airport

Zoning

None

Access/Frontage

GSP runway and GSP Dr

Runway Access

Yes

Railway Access

No

Distance to Interstate

I-85: 1.3 miles, **I-26:** 16.5 miles

Topography

Level to steeply sloping, northern end is graded level, southern end is sloping to steeply sloping

Flood Plain

No

Wetlands/Streams

Delineation not completed

Shape

Irregular

GSP Airport Environs Area

Yes

Building Potential

Excellent

Utilities

All available

Additional Renderings/Pictures on Page 2



GSP INTERNATIONAL
AIRPORT
ROGER MILLIKEN FIELD

Ryan Clark | Real Estate & Leasing Manager
Greenville-Spartanburg International Airport
rclark@gspairport.com | 864.848.6208



Ryan Clark | Real Estate & Leasing Manager
Greenville-Spartanburg International Airport
rclark@gspairport.com | 864.848.6208

Development Concept



Proposed Permanent MRO Facility

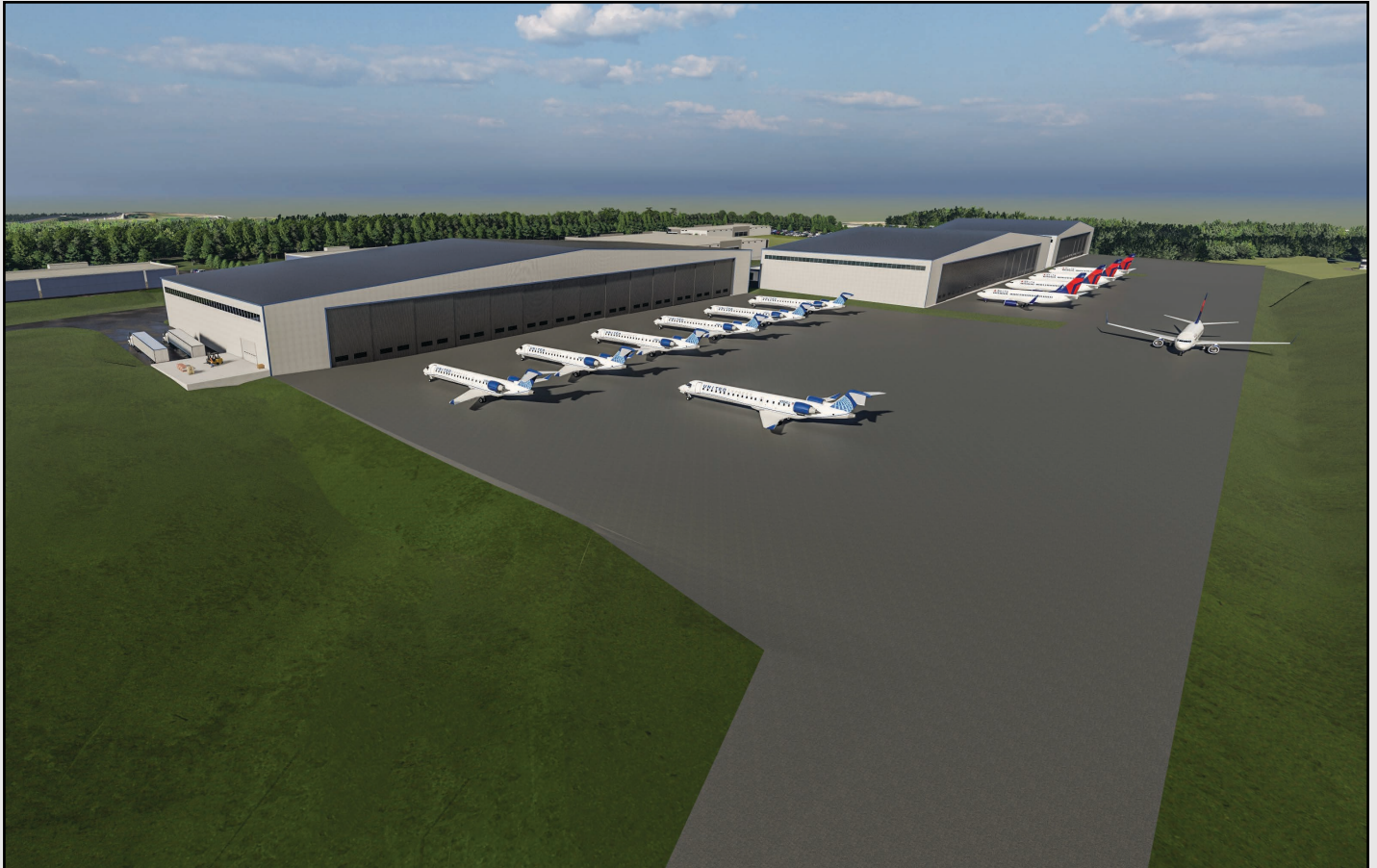

GSP INTERNATIONAL
AIRPORT
ROGER MILLIKEN FIELD

Ryan Clark | Real Estate & Leasing Manager
Greenville-Spartanburg International Airport
rclark@gspairport.com | 864.848.6208

Area Industry Map

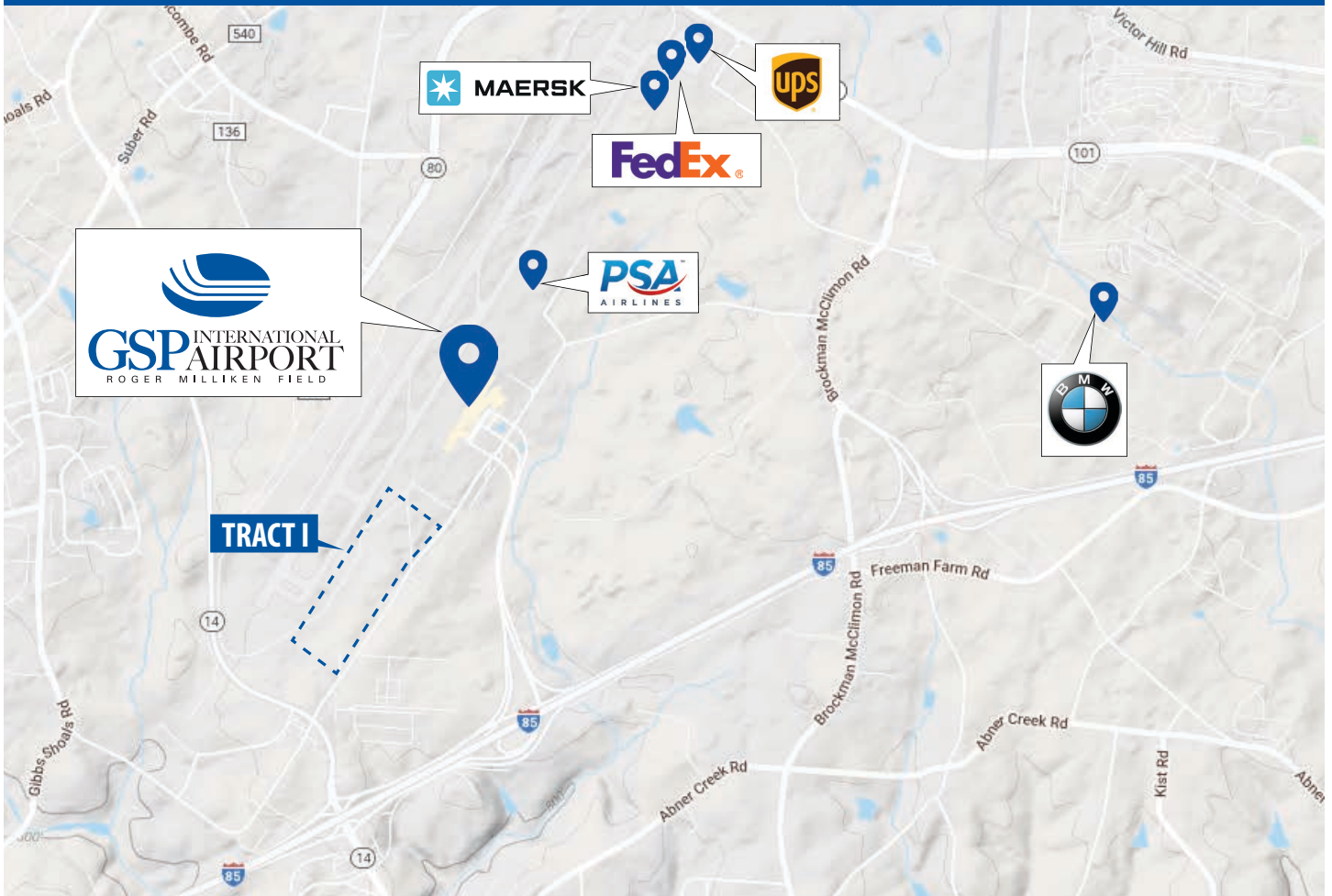

Contact:

Ryan Clark
Real Estate & Leasing Manager
Greenville-Spartanburg International Airport
Email: rclark@gspairport.com
P: 864.848.6208