

# TRACT I

69 Acres

Ideal for Aviation/Aviation Support

Located in Federal Opportunity Zone



## County

Majority in Greenville County, small portion within Spartanburg County

## City Limits

None

## Location

Southeast side of the GSP runway and west side of GSP Dr, tract fronts along the east side of the airport

## Zoning

None

## Access/Frontage

GSP runway and GSP Dr

## Runway Access

Yes

## Railway Access

No

## Distance to Interstate

**I-85:** 1.3 miles, **I-26:** 16.5 miles

## Topography

Level to steeply sloping, northern end is graded level, southern end is sloping to steeply sloping

## Flood Plain

No

## Wetlands/Streams

Delineation not completed

## Shape

Irregular

## GSP Airport Environs Area

Yes

## Building Potential

Excellent

## Utilities

All available

*Additional Renderings/Pictures on Page 2*



Mimi Thomas | Business Development Specialist  
Greenville-Spartanburg International Airport  
mthomas@gspairport.com | 864.848.6212

# Development Concept

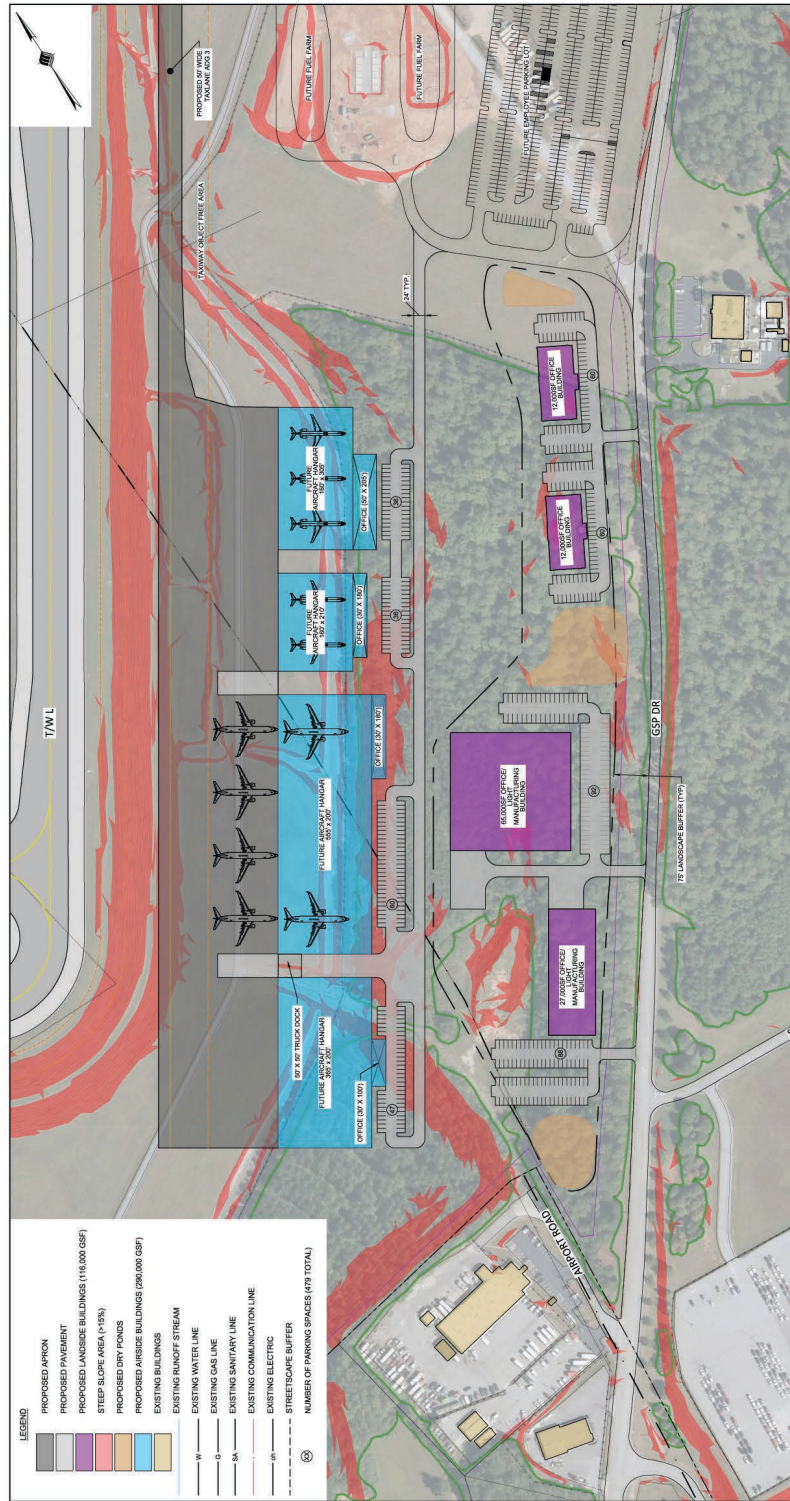

**GSP** INTERNATIONAL  
AIRPORT  
ROGER MILLIKEN FIELD

Mimi Thomas | Business Development Specialist  
Greenville-Spartanburg International Airport  
mthomas@gspairport.com | 864.848.6212



# Development Concept



## Proposed Permanent MRO Facility

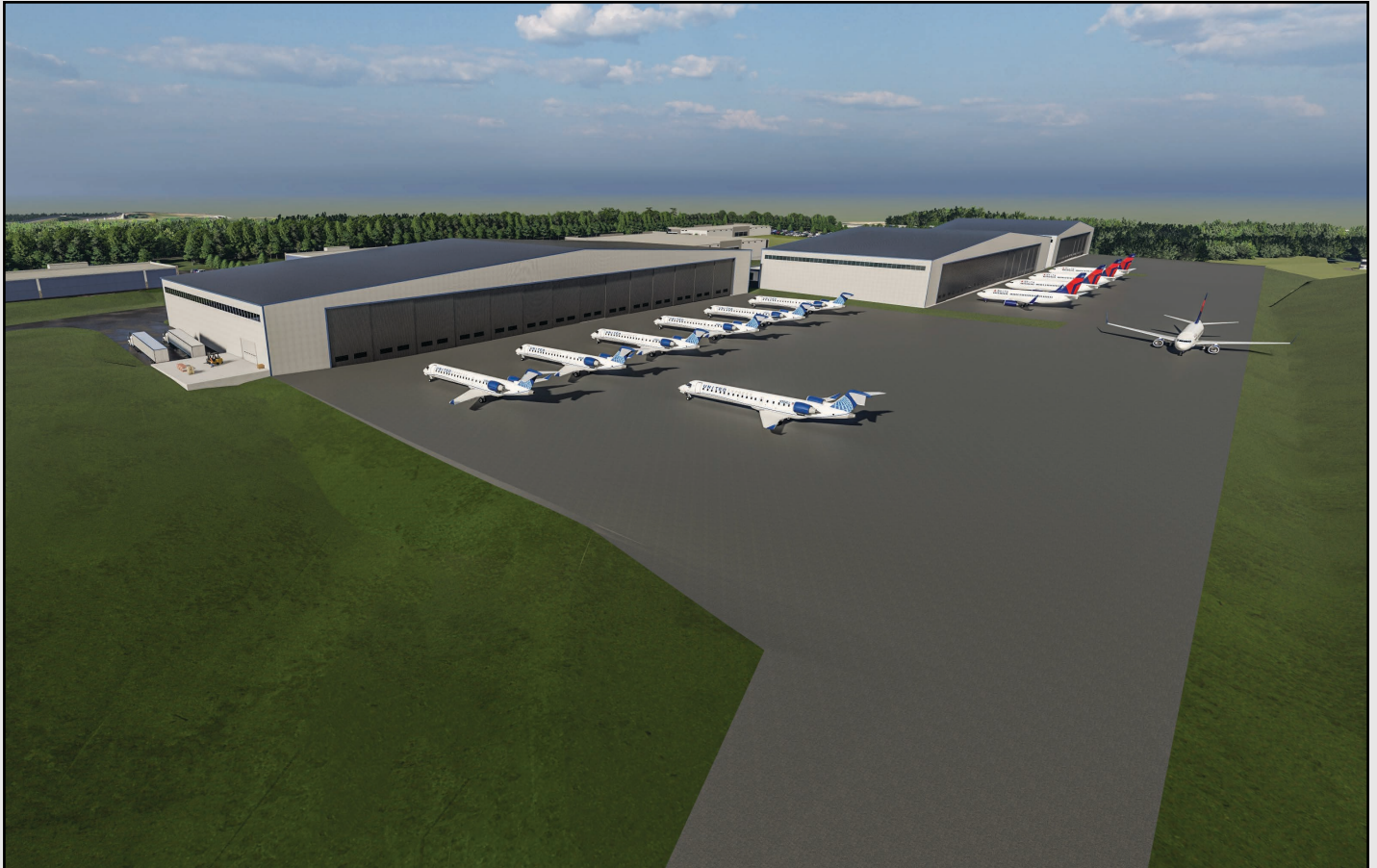

**GSP** INTERNATIONAL  
AIRPORT  
ROGER MILLIKEN FIELD

Mimi Thomas | Business Development Specialist  
Greenville-Spartanburg International Airport  
[mthomas@gspairport.com](mailto:mthomas@gspairport.com) | 864.848.6212

# Area Industry Map

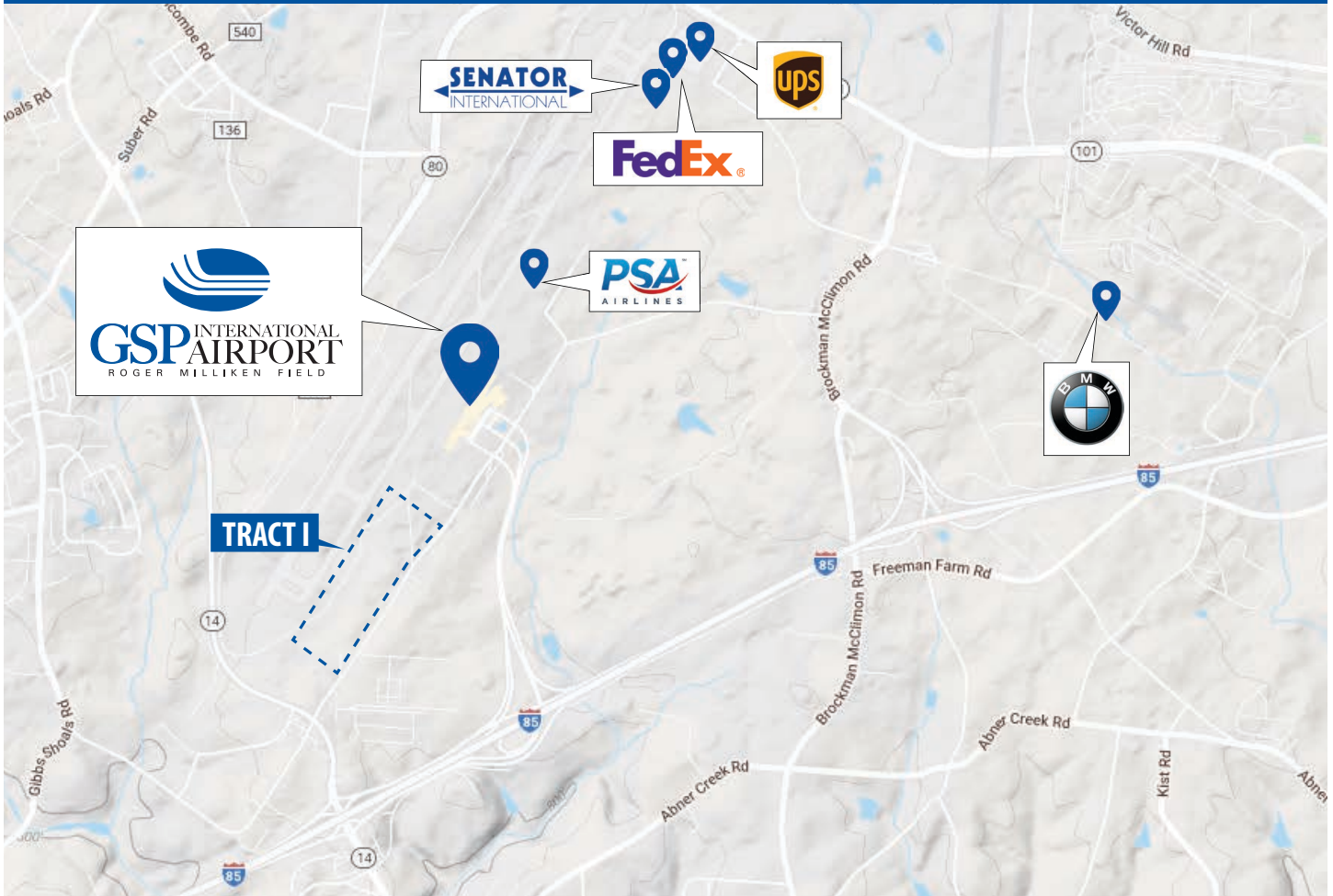

## Contact:

Mimi Thomas  
Business Development Specialist  
Greenville-Spartanburg International Airport  
Email: [mthomas@gspairport.com](mailto:mthomas@gspairport.com)  
P: 864.848.6212